





Welcome to Heritage Hall, featuring The Heritage at Acworth's luxury cityhomes and commercial spaces built by my trusted team at the JW Collection.

More than just a place to live, work, and play, Heritage Hall offers the peace of mind that comes with choosing a home crafted by experts who prioritize innovative quality, attention to detail, and long-term value.

With over 50 years of experience and a dedication to excellence, The JW Collection is committed to upholding our mission, "To conceive and build homes and neighborhoods that will stand the test of time in value and beauty and enhance the lives of their owners."

- John Wieland, Founder, The JW Collection

### Cityhomes

- THREE STORIES
- 3,531 SQ. FT. | 3 BD, 3.5 BA
- INCLUDED ELEVATOR
- THREE-CAR GARAGE
- FINISHED TERRACE LEVEL
- COVERED FRONT PORCH, BALCONY AND COVERED REAR PORCH

### Commercial Spaces

- 10' CEILINGS
- ABUNDANT NATURAL LIGHT
- PRIVATE COMMERCIAL ENTRYWAYS



*John Wieland is  
inducted into the  
Georgia Housing  
Hall of Fame.*

*John Wieland  
accepts the  
National Housing  
Quality Award.*

**1970**

**1991**

**1994**

**1995**

*John begins  
building using a  
Volkswagen Bug as  
his office and  
delivery truck.*

*Professional Builder  
Magazine designates  
John Wieland  
National Builder of  
the Year.*





*John Wieland  
is recognized as  
America's Best  
Builder by Builder  
Magazine.*

*John Wieland  
celebrates his  
fiftieth year building  
better homes.*

**2002**

**2005**

**2012**

**2020**

**2024**

*John Wieland is  
recognized with the  
Hearthstone  
Builder Lifetime  
Public Service  
Award.*

*The JW Collection  
is formed as a one-  
of-a-kind collection  
of urban, walkable  
destinations of  
individually detailed  
homes.*

*John Wieland and  
the JW Collection  
team break ground  
on Heritage Hall.*

SOLD





SOLD

Heritage Hall Cityhomes 30-33







SOUTHSIDE DRIVE

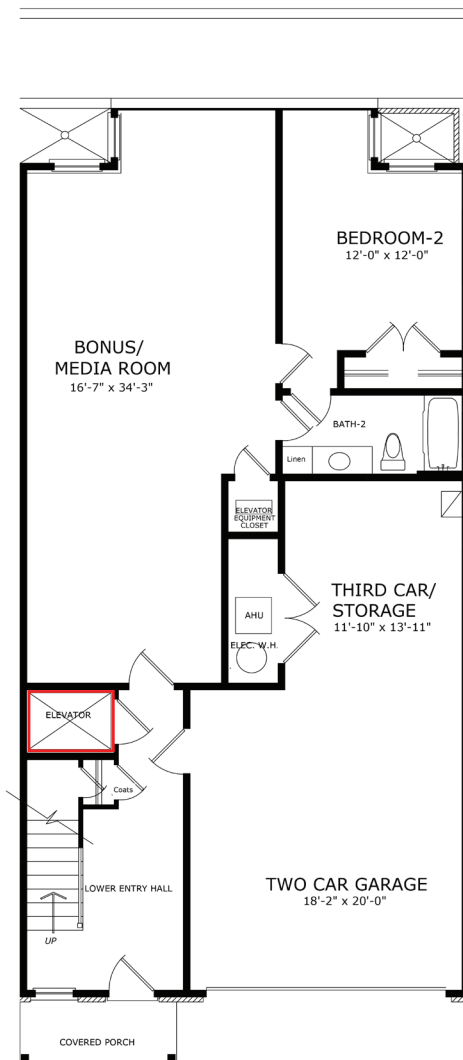

TERRACE LEVEL

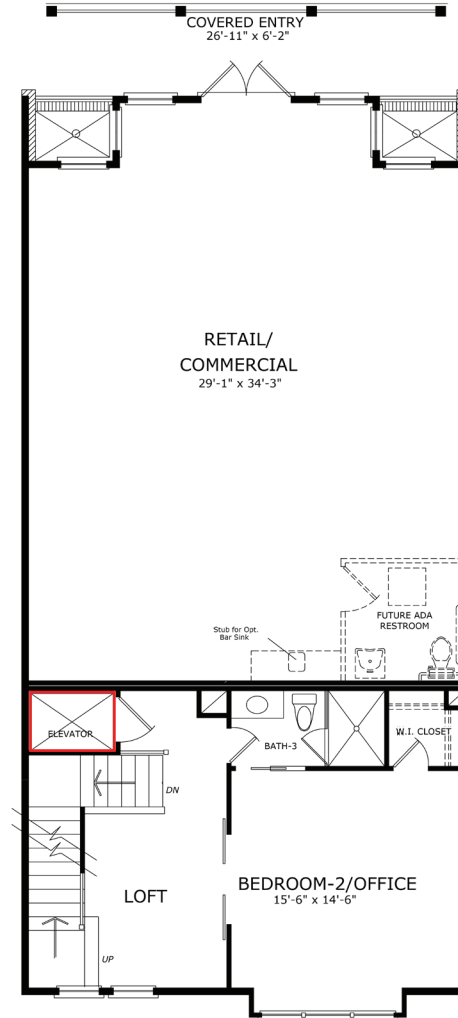

FIRST FLOOR

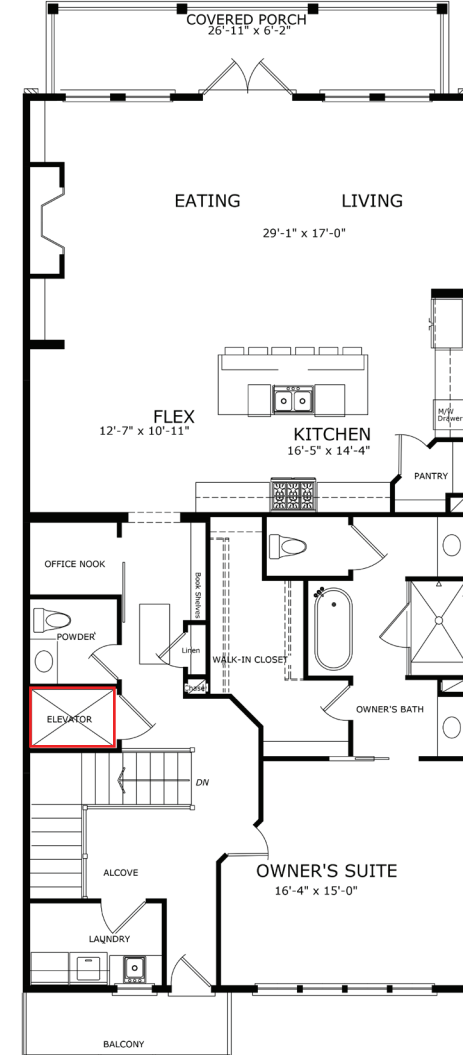

SECOND FLOOR

COURTYARD + FIRE PIT





BROWN AND  
BROWN  
CPA





Heritage Hall Commercial Spaces 29-26



## In the Heart of Downtown Acworth.

Nestled in the heart of Acworth, Heritage Hall offers an exceptional location for homeowners and business owners alike. Stroll to dining and boutique shopping on Acworth's Main Street, or enjoy a serene walk through Logan Farm Park and along the Tanyard Creek Trail.

With Lakes Acworth and Allatoona just minutes away and effortless access to I-575, you're seamlessly connected to Atlanta and beyond.

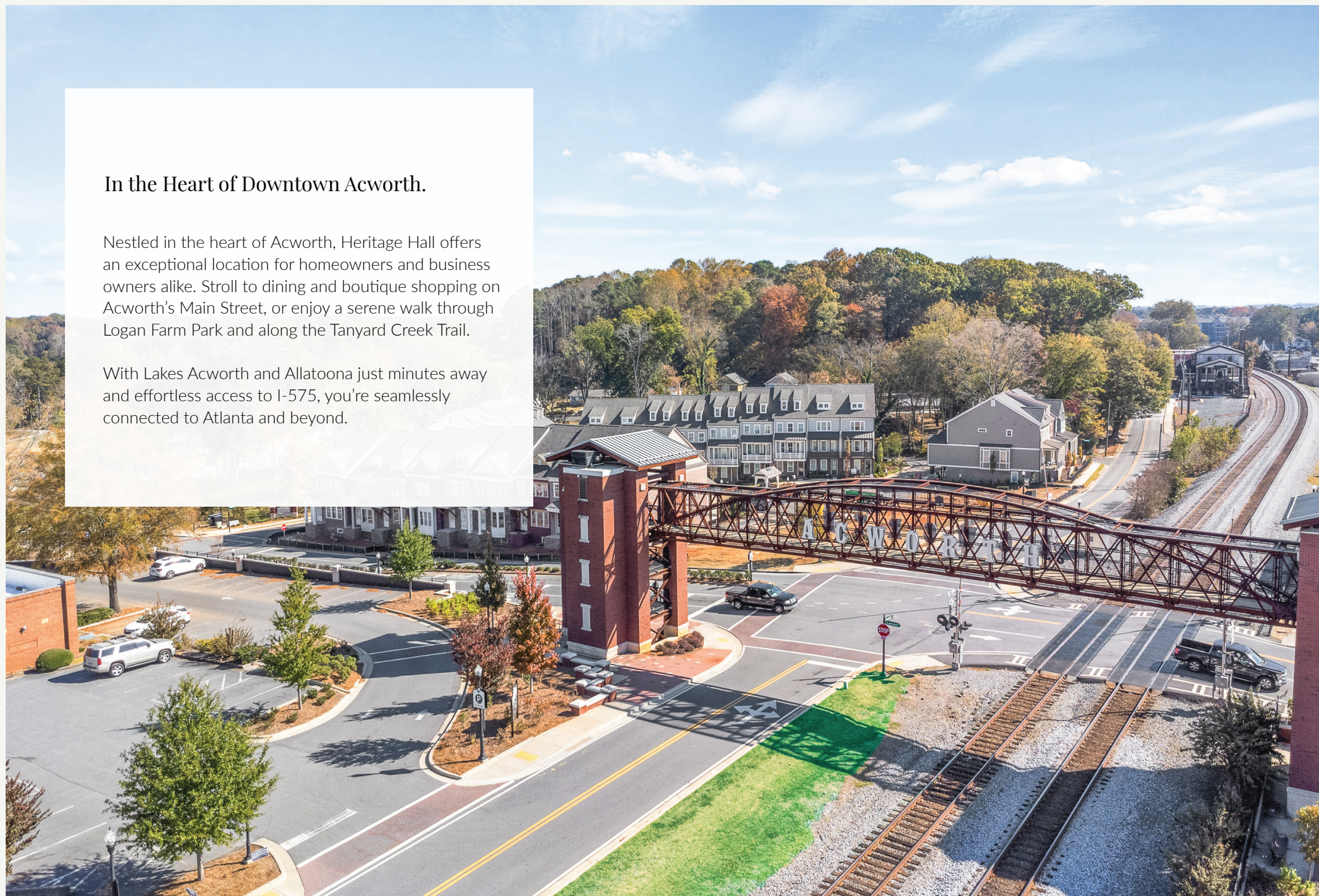



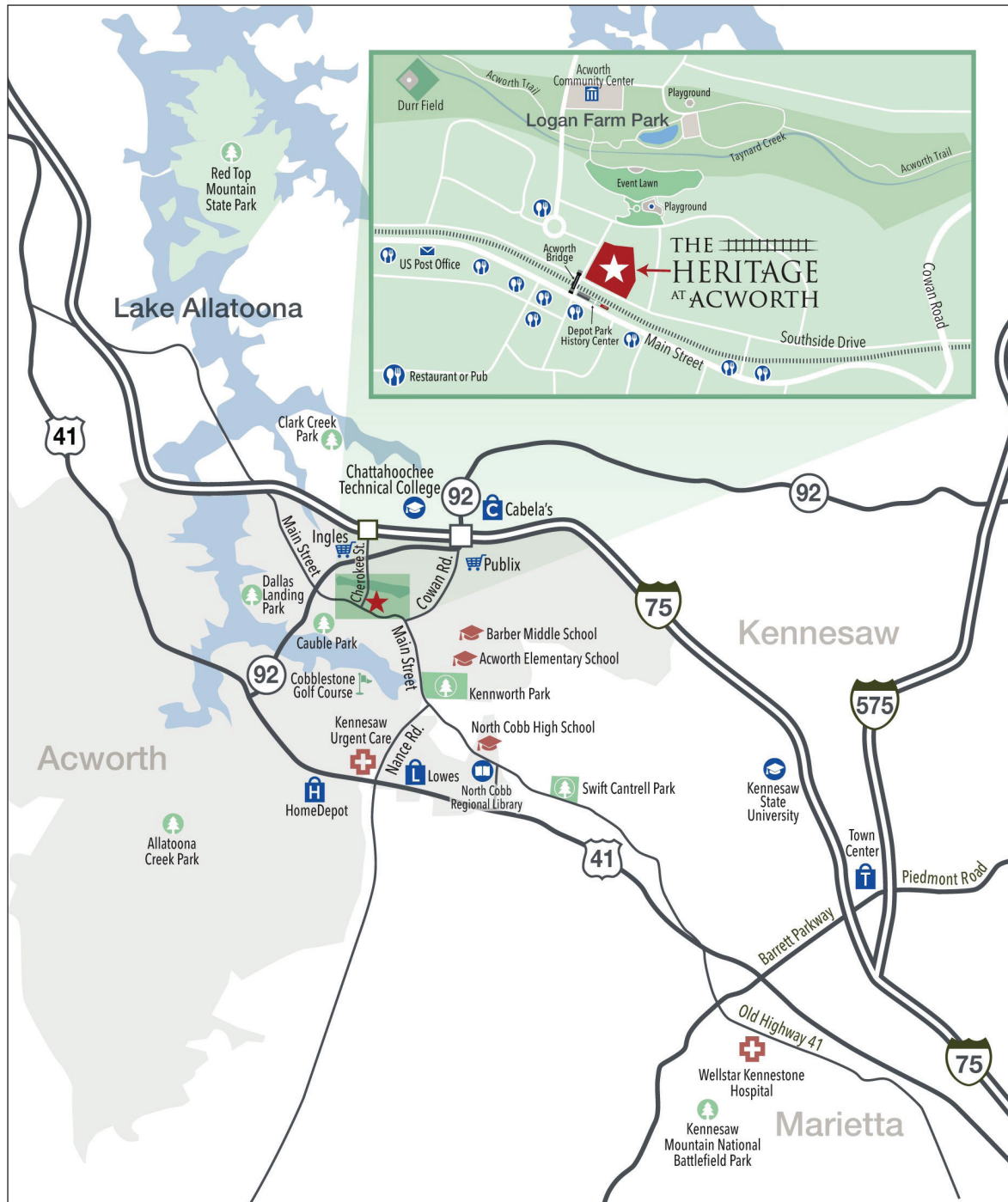







## An Exclusive Design Experience

At the JW Collection, your vision and ideas inspire the customization of your home. When you visit the exclusive JW Collection New Home Design Studio, you'll work one-on-one with an experienced interior designer to bring your ideas to life.

From premium cabinetry, finishes, appliances, bath fixtures, lighting, and millwork, our designers will guide you in curating a personalized home that reflects your unique lifestyle, ensuring both beauty and functionality in your living spaces.





4318 SOUTHSIDE DRIVE, ACWORTH, GA 30101  
HERITAGEATACWORTH.COM  
770-853-1088

